



High Resolution - Fixed Lens Color Camera

TYPE: OV-FLCC-5

Details:

- Fixed wide Angle Lens, 3.5mm
- Horizontal Angle of View: >50° (wide)
- Length: 182.5mm
- Width: 80mm
- Weight: 3kg (air)
- Depth: 1000m (standard)
- Minimum illumination:
0.01Lux at F1.8, 1/4s 50IRE
- Resolution: 570TVL (NTSC) and 560TVL (PAL)
- Power Supply: 12-24VDC, or
120VAC/230VAC 50/60Hz
- Power consumption: 5Watt



General Description

This new improved version of Low Light camera has a better resolution and also water corrected sapphire glass. This color fixed lens camera is a versatile camera used for several purposes. Typically ideal for standard anchor bolster systems, guide wire systems and also on ROV's. It is manufactured in Stainless Steel AISI316L, is durable and maintenance free. With a standard composite 1.0Vp-p video signal with an SN ratio more than 50dB the camera will send a crisp and clear video signal to the monitor. The focus can either be set to automatic or manual override. It is equipped with a special sub-sea corrective lens for optimal images under water, thus further enhancing the light sensitivity compared to previous models.

Configuration(s):

PN

- With sub. Connector IL5M (PAL) 900132
- With sub. Connector IL5M (NTSC) 900133
- With Other Connector type please specify type. -01

Dimensional Drawing

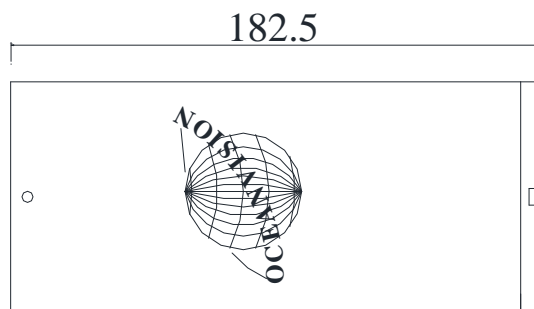

SIDE ELEVATION
OV-FLCC-5
(COMPLETE UNIT)

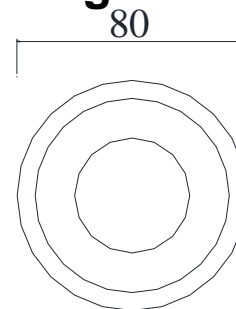

FRONT ELEVATION
OV-FLCC-5
(MAIN BODY)

All Dimension in mm.

